

LNG[®]

AUTOMOTIVE PARTS

CATÁLOGO TÉCNICO

Índice

Junta Universal

Pag. 02 - Tipo: Terminal - Cruzeta - Terminal

Pag. 10 - Tipo: Flange - Flange de Orelha - Cruzeta - Terminal

Tabela de Conversões

Pag. 12 - Juntas e seus Componentes



Cruzetas

Pág. 14 - Principais Dimensões e Posição da Graxeira



edição:
29/03/2016

WWW.LNG.COM.BR

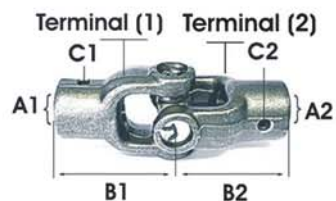

CRUZETA 801039
 ØB = 23,80
 A = 61,20
 posição da graxeira = CENTRO

CRUZETA 801104
 ØB = 19,00
 A = 48,20
 posição da graxeira = CENTRO

CÓDIGO JUNTA	COMPONENTES		A1 - A2 (FURO QUADRADO)	A1 - A2 (FURO REDONDO)		B1 - B2 (MM)		C1 - C2 (Ø FURO TRANSV.)	CÓDIGO CRUZETA	OBS.
	DESCRIÇÃO	CÓDIGO		COM CHAVETA	SEM CHAVETA	CURTO	LONGO			
28-033	TERMINAL 1	28-079	---	20,80 - 13/16"	---	77,50	---	3/8"	801104	---
	TERMINAL 2	28-060	---	---	20,80 - 13/16"	78	---	8mm		---
28-034	TERMINAL 1	28-079	---	20,80 - 13/16"	---	77,50	---	3/8"	801104	---
	TERMINAL 2	28-080	19,30 - 49/64"	---	---	---	125	1/4"		---
28-035	TERMINAL 1	28-060	---	---	20,80 - 13/16"	78,00	---	8mm	801104	---
	TERMINAL 2	28-081	19,30 - 49/64"	---	---	77	---	8mm		---
28-036	TERMINAL 1	28-079	---	20,80 - 13/16"	---	77,50	---	3/8"	801104	---
	TERMINAL 2	28-081	19,30 - 49/64"	---	---	77	---	8mm		---
28-037	TERMINAL 1	28-083	---	25,40 - 1"	---	76,5	---	3/8"	801104	---
	TERMINAL 2	28-083	---	25,40 - 1"	---	76,5	---	3/8"		---
28-038	TERMINAL 1	28-083	---	25,40 - 1"	---	76,5	---	3/8"	801104	---
	TERMINAL 2	28-084	---	25,40 - 1"	---	---	126	3/8"		---
28-039	TERMINAL 1	28-083	---	25,40 - 1"	---	76,5	---	3/8"	801104	---
	TERMINAL 2	28-080	19,30 - 49/64"	---	---	---	125	1/4"		---
28-044	TERMINAL 1	28-079	---	20,80 - 13/16"	---	77,50	---	3/8"	801104	---
	TERMINAL 2	28-079	---	20,80 - 13/16"	---	77,5	---	3/8"		---
28-045	TERMINAL 1	28-079	---	20,80 - 13/16"	---	77,50	---	3/8"	801104	---
	TERMINAL 2	28-083	---	25,40 - 1"	---	76,5	---	3/8"		---
28-046	TERMINAL 1	28-079	---	20,80 - 13/16"	---	77,50	---	3/8"	801104	---
	TERMINAL 2	28-088	22,30 - 7/8"	---	---	77	---	8mm		---
28-049	TERMINAL 1	28-083	---	25,40 - 1"	---	76,5	---	3/8"	801104	---
	TERMINAL 2	28-081	19,30 - 49/64"	---	---	77	---	8mm		---
28-050	TERMINAL 1	28-079	---	20,80 - 13/16"	---	77,50	---	3/8"	801104	---
	TERMINAL 2	28-091	22,20 - 7/8"	---	---	---	125	1/4"		---

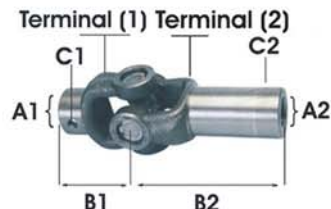
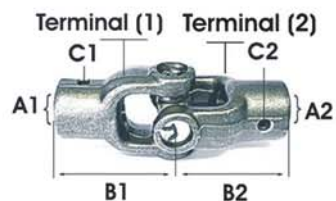

CRUZETA 801039
 ØB = 23,80
 A = 61,20
 posição da graxeira = CENTRO

CRUZETA 801104
 ØB = 19,00
 A = 48,20
 posição da graxeira = CENTRO

CÓDIGO JUNTA	COMPONENTES		A1 - A2 (FURO QUADRADO)	A1 - A2 (FURO REDONDO)		B1 - B2 (MM)		C1 - C2 (Ø FURO TRANSV.)	CÓDIGO CRUZETA	OBS.
	DESCRIÇÃO	CÓDIGO		COM CHAVETA	SEM CHAVETA	CURTO	LONGO			
28-051	TERMINAL 1	28-079	---	20,80 - 13/16"	---	77,50	---	3/8"	801104	---
	TERMINAL 2	28-092	28,60 - 1 1/8"	---	---	59	---	8mm		---
28-052	TERMINAL 1	28-060	---	---	20,80 - 13/16"	78,00	---	8mm	801104	---
	TERMINAL 2	28-060	---	---	20,80 - 13/16"	78	---	8mm		---
28-053	TERMINAL 1	28-060	---	---	20,80 - 13/16"	78,00	---	8mm	801104	---
	TERMINAL 2	28-082	---	22,40 - 7/8"	---	77,5	---	3/8"		---
28-054	TERMINAL 1	28-081	19,30 - 49/64"	---	---	77	---	8mm	801104	---
	TERMINAL 2	28-081	19,30 - 49/64"	---	---	77	---	8mm		---
28-055	TERMINAL 1	28-082	---	22,40 - 7/8"	---	77,5	---	3/8"	801104	---
	TERMINAL 2	28-080	19,30 - 49/64"	---	---	---	125	1/4"		---
28-056	TERMINAL 1	28-082	---	22,40 - 7/8"	---	77,5	---	3/8"	801104	---
	TERMINAL 2	28-081	19,30 - 49/64"	---	---	77	---	8mm		---
28-057	TERMINAL 1	28-082	---	22,40 - 7/8"	---	77,5	---	3/8"	801104	---
	TERMINAL 2	28-082	---	22,40 - 7/8"	---	77,5	---	3/8"		---
28-058	TERMINAL 1	28-082	---	22,40 - 7/8"	---	77,5	---	3/8"	801104	---
	TERMINAL 2	28-088	22,30 - 7/8"	---	---	77	---	8mm		---
28-059	TERMINAL 1	28-082	---	22,40 - 7/8"	---	77,5	---	3/8"	801104	---
	TERMINAL 2	28-091	22,20 - 7/8"	---	---	---	125	1/4"		---
28-072	TERMINAL 1	28-072	---	22,20 - 7/8"	---	71,00	---	3/8"	801039	---
	TERMINAL 2	28-072	---	22,20 - 7/8"	---	71,00	---	3/8"		---
28-119	TERMINAL 1	28-083	---	25,40 - 1"	---	76,5	---	3/8"	801104	---
	TERMINAL 2	28-079	---	20,80 - 13/16"	---	77,5	---	3/8"		---
28-120	TERMINAL 1	28-083	---	25,40 - 1"	---	76,5	---	3/8"	801104	---
	TERMINAL 2	28-060	---	---	20,80 - 13/16"	78	---	8mm		---

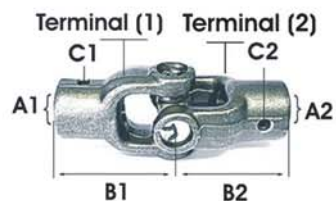

CRUZETA 801039
 ØB = 23,80
 A = 61,20
 posição da graxeira = CENTRO

CRUZETA 801104
 ØB = 19,00
 A = 48,20
 posição da graxeira = CENTRO

CÓDIGO JUNTA	COMPONENTES		A1 - A2 (FURO QUADRADO)	A1 - A2 (FURO REDONDO)		B1 - B2 (MM)		C1 - C2 (Ø FURO TRANSV.)	CÓDIGO CRUZETA	OBS.
	DESCRIÇÃO	CÓDIGO		COM CHAVETA	SEM CHAVETA	CURTO	LONGO			
28-121	TERMINAL 1	28-083	---	25,40 - 1"	---	76,5	---	3/8"	801104	---
	TERMINAL 2	28-088	22,30 - 7/8"	---	---	77	---	8mm		---
28-122	TERMINAL 1	28-083	---	25,40 - 1"	---	76,5	---	3/8"	801104	---
	TERMINAL 2	28-091	22,20 - 7/8"	---	---	---	125	1/4"		---
28-123	TERMINAL 1	28-083	---	25,40 - 1"	---	76,5	---	3/8"	801104	---
	TERMINAL 2	28-092	28,60 - 1 1/8"	---	---	59	---	8mm		---
28-124	TERMINAL 1	28-084	---	25,40 - 1"	---	---	126	3/8"	801104	---
	TERMINAL 2	28-081	19,30 - 49/64"	---	---	77	---	8mm		---
28-125	TERMINAL 1	28-084	---	25,40 - 1"	---	---	126	3/8"	801104	---
	TERMINAL 2	28-088	22,30 - 7/8"	---	---	77	---	8mm		---
28-126	TERMINAL 1	28-084	---	25,40 - 1"	---	---	126	3/8"	801104	---
	TERMINAL 2	28-091	22,20 - 7/8"	---	---	---	125	1/4"		---
28-127	TERMINAL 1	28-086	---	20,80 - 13/16"	---	---	126	3/8"	801104	---
	TERMINAL 2	28-088	22,30 - 7/8"	---	---	77	---	8mm		---
28-128	TERMINAL 1	28-086	---	20,80 - 13/16"	---	---	126	3/8"	801104	---
	TERMINAL 2	28-092	28,60 - 1 1/8"	---	---	59	---	8mm		---
28-129	TERMINAL 1	28-089	---	19,20 - 3/4"	---	77	---	5/16"	801104	---
	TERMINAL 2	28-079	---	20,80 - 13/16"	---	77,5	---	3/8"		---
28-130	TERMINAL 1	28-089	---	19,20 - 3/4"	---	77	---	5/16"	801104	---
	TERMINAL 2	28-080	19,30 - 49/64"	---	---	---	125	1/4"		---
28-131	TERMINAL 1	28-089	---	19,20 - 3/4"	---	77	---	5/16"	801104	---
	TERMINAL 2	28-081	19,30 - 49/64"	---	---	77	---	8mm		---
28-132	TERMINAL 1	28-089	---	19,20 - 3/4"	---	77	---	5/16"	801104	---
	TERMINAL 2	28-083	---	25,40 - 1"	---	76,5	---	3/8"		---

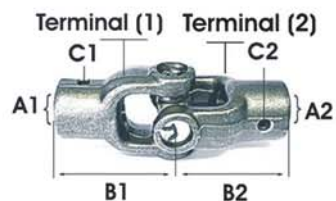

CRUZETA 801039
 ØB = 23,80
 A = 61,20
 posição da graxeira = CENTRO

CRUZETA 801104
 ØB = 19,00
 A = 48,20
 posição da graxeira = CENTRO

CÓDIGO JUNTA	COMPONENTES		A1 - A2 (FURO QUADRADO)	A1 - A2 (FURO REDONDO)		B1 - B2 (MM)		C1 - C2 (Ø FURO TRANSV.)	CÓDIGO CRUZETA	OBS.
	DESCRIÇÃO	CÓDIGO		COM CHAVETA	SEM CHAVETA	CURTO	LONGO			
28-133	TERMINAL 1	28-084	---	25,40 - 1"	---	---	126	3/8"	801104	---
	TERMINAL 2	28-092	28,60 - 1 1/8"	---	---	59	---	8mm		---
28-134	TERMINAL 1	28-066	---	20,70 - 13/16"	---	74,00	---	3/8"	801039	---
	TERMINAL 2	28-062	28,50 - 1 1/8"	---	---	61	---	8mm		---
28-135	TERMINAL 1	28-066	---	20,70 - 13/16"	---	74,00	---	3/8"	801039	---
	TERMINAL 2	28-067	---	25,40 - 1"	---	71,00	---	3/8"		---
28-136	TERMINAL 1	28-066	---	20,70 - 13/16"	---	74,00	---	3/8"	801039	---
	TERMINAL 2	28-070	---	20,70 - 13/16"	---	---	139,5	3/8"		---
28-137	TERMINAL 1	28-066	---	20,70 - 13/16"	---	74,00	---	3/8"	801039	---
	TERMINAL 2	28-074	19,30 - 49/64"	---	---	71	---	8mm		---
28-138	TERMINAL 1	28-066	---	20,70 - 13/16"	---	74,00	---	3/8"	801039	---
	TERMINAL 2	28-075	19,40 - 49/64"	---	---	---	139,5	1/4"		---
28-139	TERMINAL 1	28-066	---	20,70 - 13/16"	---	74,00	---	3/8"	801039	---
	TERMINAL 2	28-076	22,20 - 7/8"	---	---	---	138,5	SEM FURO		---
28-140	TERMINAL 1	28-067	---	25,40 - 1"	---	71	---	3/8"	801039	---
	TERMINAL 2	28-062	28,50 - 1 1/8"	---	---	61	---	8mm		---
28-141	TERMINAL 1	28-067	---	25,40 - 1"	---	71	---	3/8"	801039	---
	TERMINAL 2	28-067	---	25,40 - 1"	---	71,00	---	3/8"		---
28-142	TERMINAL 1	28-067	---	25,40 - 1"	---	71	---	3/8"	801039	---
	TERMINAL 2	28-071	---	25,40 - 1"	---	---	139,5	3/8"		---
28-143	TERMINAL 1	28-067	---	25,40 - 1"	---	71	---	3/8"	801039	---
	TERMINAL 2	28-072	---	22,20 - 7/8"	---	71,00	---	3/8"		---
28-144	TERMINAL 1	28-067	---	25,40 - 1"	---	71	---	3/8"	801039	---
	TERMINAL 2	28-074	19,30 - 49/64"	---	---	71	---	8mm		---

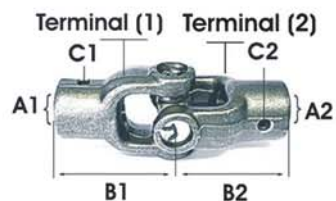

CRUZETA 801039
 ØB = 23,80
 A = 61,20
 posição da graxeira = CENTRO

CRUZETA 801104
 ØB = 19,00
 A = 48,20
 posição da graxeira = CENTRO

CÓDIGO JUNTA	COMPONENTES		A1 - A2 (FURO QUADRADO)	A1 - A2 (FURO REDONDO)		B1 - B2 (MM)		C1 - C2 (Ø FURO TRANSV.)	CÓDIGO CRUZETA	OBS.
	DESCRIÇÃO	CÓDIGO		COM CHAVETA	SEM CHAVETA	CURTO	LONGO			
28-145	TERMINAL 1	28-067	---	25,40 - 1"	---	71	---	3/8"	801039	---
	TERMINAL 2	28-075	19,40 - 49/64"	---	---	---	139,5	1/4"		---
28-146	TERMINAL 1	28-067	---	25,40 - 1"	---	71	---	3/8"	801039	---
	TERMINAL 2	28-076	22,20 - 7/8"	---	---	---	138,5	SEM FURO		---
28-147	TERMINAL 1	28-068	---	22,18 - 1 1/4"	---	---	138,5	3/8"	801039	---
	TERMINAL 2	28-061	22,20 - 7/8"	---	---	71,5	---	8mm		---
28-148	TERMINAL 1	28-068	---	22,18 - 1 1/4"	---	---	138,5	3/8"	801039	---
	TERMINAL 2	28-076	22,20 - 7/8"	---	---	---	138,5	SEM FURO		---
28-149	TERMINAL 1	28-070	---	20,70 - 13/16"	---	---	139,5	3/8"	801039	---
	TERMINAL 2	28-061	22,20 - 7/8"	---	---	71,5	---	8mm		---
28-150	TERMINAL 1	28-070	---	20,70 - 13/16"	---	---	139,5	3/8"	801039	---
	TERMINAL 2	28-062	28,50 - 1 1/8"	---	---	61	---	8mm		---
28-151	TERMINAL 1	28-070	---	20,70 - 13/16"	---	---	139,5	3/8"	801039	---
	TERMINAL 2	28-076	22,20 - 7/8"	---	---	---	138,5	SEM FURO		---
28-152	TERMINAL 1	28-071	---	25,40 - 1"	---	---	139,5	3/8"	801039	---
	TERMINAL 2	28-061	22,20 - 7/8"	---	---	71,5	---	8mm		---
28-153	TERMINAL 1	28-071	---	25,40 - 1"	---	---	139,5	3/8"	801039	---
	TERMINAL 2	28-062	28,50 - 1 1/8"	---	---	61	---	8mm		---
28-154	TERMINAL 1	28-071	---	25,40 - 1"	---	---	139,5	3/8"	801039	---
	TERMINAL 2	28-074	19,30 - 49/64"	---	---	71	---	8mm		---
28-155	TERMINAL 1	28-071	---	25,40 - 1"	---	---	139,5	3/8"	801039	---
	TERMINAL 2	28-076	22,20 - 7/8"	---	---	---	138,5	SEM FURO		---
28-156	TERMINAL 1	28-072	---	22,20 - 7/8"	---	71	---	3/8"	801039	---
	TERMINAL 2	28-061	22,20 - 7/8"	---	---	71,5	---	8mm		---

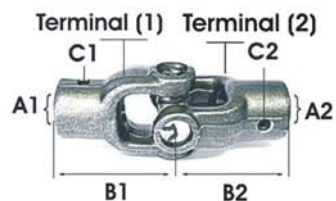

CRUZETA 801039
 ØB = 23,80
 A = 61,20
 posição da graxeira = CENTRO

CRUZETA 801104
 ØB = 19,00
 A = 48,20
 posição da graxeira = CENTRO

CÓDIGO JUNTA	COMPONENTES		A1 - A2 (FURO QUADRADO)	A1 - A2 (FURO REDONDO)		B1 - B2 (MM)		C1 - C2 (Ø FURO TRANSV.)	CÓDIGO CRUZETA	OBS.
	DESCRIÇÃO	CÓDIGO		COM CHAVETA	SEM CHAVETA	CURTO	LONGO			
28-157	TERMINAL 1	28-062	28,50 - 1 1/8"	---	---	61,00	---	8mm	801039	---
	TERMINAL 2	28-074	19,30 - 49/64"	---	---	71	---	8mm		---
28-158	TERMINAL 1	28-072	---	22,20 - 7/8"	---	71	---	3/8"	801039	---
	TERMINAL 2	28-074	19,30 - 49/64"	---	---	71	---	8mm		---
28-159	TERMINAL 1	28-072	---	22,20 - 7/8"	---	71	---	3/8"	801039	---
	TERMINAL 2	28-076	22,20 - 7/8"	---	---	---	138,5	SEM FURO		---
28-160	TERMINAL 1	28-073	---	31,70 - 1 1/4"	---	71,5	---	3/8"	801039	---
	TERMINAL 2	28-061	22,20 - 7/8"	---	---	71,5	---	8mm		---
28-161	TERMINAL 1	28-073	---	31,70 - 1 1/4"	---	71,5	---	3/8"	801039	---
	TERMINAL 2	28-062	28,50 - 1 1/8"	---	---	61	---	8mm		---
28-162	TERMINAL 1	28-073	---	31,70 - 1 1/4"	---	71,5	---	3/8"	801039	---
	TERMINAL 2	28-067	---	25,40 - 1"	---	71,00	---	3/8"		---
28-163	TERMINAL 1	28-073	---	31,70 - 1 1/4"	---	71,5	---	3/8"	801039	---
	TERMINAL 2	28-073	---	31,70 - 1 1/4"	---	71,50	---	3/8"		---
28-164	TERMINAL 1	28-073	---	31,70 - 1 1/4"	---	71,5	---	3/8"	801039	---
	TERMINAL 2	28-076	22,20 - 7/8"	---	---	---	138,5	SEM FURO		---
28-165	TERMINAL 1	28-094	---	---	27,00 - 1 1/16"	---	138,5	Graxeira 6mm	801039	Terminal (Luva) 16 estrias - Estriado
	TERMINAL 2	28-066	---	20,70 - 13/16"	---	74	---	3/8"		---
28-166	TERMINAL 1	28-094	---	---	27,00 - 1 1/16"	---	138,5	Graxeira 6mm	801039	Terminal (Luva) 16 estrias - Estriado
	TERMINAL 2	28-067	---	25,40 - 1"	---	71,00	---	3/8"		---
28-167	TERMINAL 1	28-094	---	---	27,00 - 1 1/16"	---	138,5	Graxeira 6mm	801039	Terminal (Luva) 16 estrias - Estriado
	TERMINAL 2	28-071	---	25,40 - 1"	---	---	139,5	3/8"		---
28-168	TERMINAL 1	28-094	---	---	27,00 - 1 1/16"	---	138,5	Graxeira 6mm	801039	Terminal (Luva) 16 estrias - Estriado
	TERMINAL 2	28-072	---	22,20 - 7/8"	---	71,00	---	3/8"		---

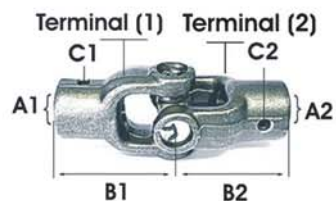

CRUZETA 801039
 ØB = 23,80
 A = 61,20
 posição da graxeira = CENTRO

CRUZETA 801104
 ØB = 19,00
 A = 48,20
 posição da graxeira = CENTRO

CÓDIGO JUNTA	COMPONENTES		A1 - A2 (FURO QUADRADO)	A1 - A2 (FURO REDONDO)		B1 - B2 (MM)		C1 - C2 (Ø FURO TRANSV.)	CÓDIGO CRUZETA	OBS.
	DESCRIÇÃO	CÓDIGO		COM CHAVETA	SEM CHAVETA	CURTO	LONGO			
28-182	TERMINAL 1	28-063	---	30,10 - 1 3/16"	---	71	---	10mm	801039	---
	TERMINAL 2	28-087	---	20,60 - 13/16"	---	71,5	---	3/8"		---
28-183	TERMINAL 1	28-065	---	28,00 - 1 7/64"	---	71,50	---	3/8"	801039	---
	TERMINAL 2	28-062	28,50 - 1 1/8"	---	---	61	---	8mm		---
28-184	TERMINAL 1	28-069	---	31,80 - 1 1/4"	---	---	139	3/8"	801039	---
	TERMINAL 2	28-075	19,40 - 49/64"	---	---	---	139,5	1/4"		---
28-185	TERMINAL 1	28-077	---	28,00 - 1 7/64"	---	56	---	5/16"	801039	---
	TERMINAL 2	28-061	22,20 - 7/8"	---	---	71,5	---	8mm		---
28-186	TERMINAL 1	28-077	---	28,00 - 1 7/64"	---	56	---	5/16"	801039	---
	TERMINAL 2	28-062	28,50 - 1 1/8"	---	---	61	---	8mm		---
28-187	TERMINAL 1	28-078	---	19,40 - 49/64"	---	---	139,5	3/8"	801039	---
	TERMINAL 2	28-067	---	25,40 - 1"	---	71,00	---	3/8"		---
28-191	TERMINAL 1	28-084	---	25,40 - 1"	---	---	126	3/8"	801104	---
	TERMINAL 2	28-085	---	---	22,20 - 7/8"	---	125	1/4"		---
28-192	TERMINAL 1	28-090	---	28,10 - 1 7/64"	---	59	---	5/16"	801104	---
	TERMINAL 2	28-088	22,30 - 7/8"	---	---	77	---	8mm		---
28-193	TERMINAL 1	28-076	22,20 - 7/8"	---	---	---	138,5	SEM FURO	801039	---
	TERMINAL 2	28-076	22,20 - 7/8"	---	---	---	138,5	SEM FURO		---
28-194	TERMINAL 1	28-072	---	22,20 - 7/8"	---	71,00	---	3/8"	801039	---
	TERMINAL 2	28-072	---	22,20 - 7/8"	---	71,00	---	3/8"		---
28-195	TERMINAL 1	28-071	---	25,40 - 1"	---	---	139,5	3/8"	801039	---
	TERMINAL 2	28-075	19,40 - 49/64"	---	---	---	139,5	1/4"		---
28-196	TERMINAL 1	28-061	22,20 - 7/8"	---	---	71,50	---	8mm	801039	---
	TERMINAL 2	28-066	---	20,70 - 13/16"	---	74,00	---	3/8"		---

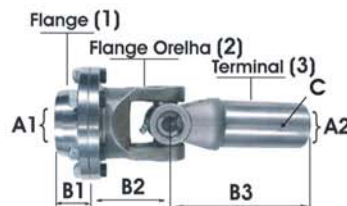
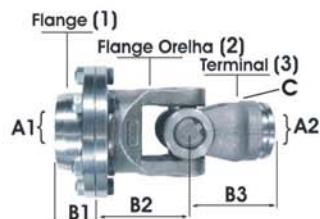

CRUZETA 801039
 ØB = 23,80
 A = 61,20
 posição da graxeira = CENTRO

CÓDIGO JUNTA	COMPONENTES		A1 - A2 (FURO QUADRADO)	A1 - A2 (FURO REDONDO)		B1 - B2 - B3 (MM)		C (Ø FURO TRANSV.)	CÓDIGO CRUZETA	OBS.
	DESCRIÇÃO	CÓDIGO		COM CHAVETA	SEM CHAVETA	CURTO	LONGO			
28-169	1-FLANGE	28-181	---	---	27,60 - 1 3/32"	39,00	---	---	801039	4 furos 8,2mm - Disco Ø 97,70mm
	2-F.ORELHA	28-100	---	---	---	83,00	---	---		4 furos 8,2mm - Disco Ø 97,70mm
	3-TERMINAL	28-074	19,30 - 49/64"	---	---	71,00	---	8mm		---
28-170	1-FLANGE	28-181	---	---	27,60 - 1 3/32"	39,00	---	---	801039	4 furos 8,2mm - Disco Ø 97,70mm
	2-F.ORELHA	28-100	---	---	---	83,00	---	---		4 furos 8,2mm - Disco Ø 97,70mm
	3-TERMINAL	28-061	22,20 - 7/8"	---	---	71,50	---	8mm		---
28-171	1-FLANGE	28-181	---	---	27,60 - 1 3/32"	39,00	---	---	801039	4 furos 8,2mm - Disco Ø 97,70mm
	2-F.ORELHA	28-100	---	---	---	83,00	---	---		4 furos 8,2mm - Disco Ø 97,70mm
	3-TERMINAL	28-062	28,50 - 1 1/8"	---	---	61,00	---	8mm		---
28-172	1-FLANGE	28-097	---	---	30,00 - 1 3/16"	30,00	---	---	801039	6 furos 8,2mm - Disco Ø 105,00mm
	2-F.ORELHA	28-095	---	---	---	70,00	---	---		6 furos 8,2mm - Disco Ø 105,00mm
	3-TERMINAL	28-075	19,40 - 49/64"	---	---	---	139,5	1/4"		---
28-173	1-FLANGE	28-097	---	---	30,00 - 1 3/16"	30,00	---	---	801039	6 furos 8,2mm - Disco Ø 105,00mm
	2-F.ORELHA	28-095	---	---	---	70,00	---	---		6 furos 8,2mm - Disco Ø 105,00mm
	3-TERMINAL	28-061	22,20 - 7/8"	---	---	71,50	---	8mm		---
28-174	1-FLANGE	28-097	---	---	30,00 - 1 3/16"	30,00	---	---	801039	6 furos 8,2mm - Disco Ø 105,00mm
	2-F.ORELHA	28-095	---	---	---	70,00	---	---		6 furos 8,2mm - Disco Ø 105,00mm
	3-TERMINAL	28-062	28,50 - 1 1/8"	---	---	61,00	---	8mm		---
28-175	1-FLANGE	28-097	---	---	30,00 - 1 3/16"	30,00	---	---	801039	6 furos 8,2mm - Disco Ø 105,00mm
	2-F.ORELHA	28-095	---	---	---	70,00	---	---		6 furos 8,2mm - Disco Ø 105,00mm
	3-TERMINAL	28-074	19,30 - 49/64"	---	---	71,00	---	8mm		---
28-176	1-FLANGE	28-097	---	---	30,00 - 1 3/16"	30,00	---	---	801039	6 furos 8,2mm - Disco Ø 105,00mm
	2-F.ORELHA	28-095	---	---	---	70,00	---	---		6 furos 8,2mm - Disco Ø 105,00mm
	3-TERMINAL	28-067	---	25,40 - 1"	---	71,00	---	3/8"		---
28-177	1-FLANGE	28-097	---	---	30,00 - 1 3/16"	30,00	---	---	801039	6 furos 8,2mm - Disco Ø 105,00mm
	2-F.ORELHA	28-095	---	---	---	70,00	---	---		6 furos 8,2mm - Disco Ø 105,00mm
	3-TERMINAL	28-071	---	25,40 - 1"	---	---	139,5	3/8"		---

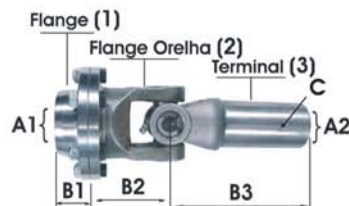
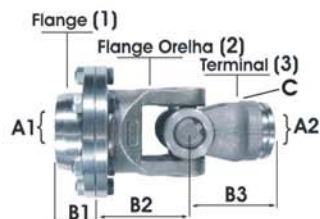

CRUZETA 801039
 ØB = 23,80
 A = 61,20
 posição da graxeira = CENTRO

CÓDIGO JUNTA	COMPONENTES		A1 - A2 (FURO QUADRADO)	A1 - A2 (FURO REDONDO)		B1 - B2 - B3 (MM)		C (Ø FURO TRANSV.)	CÓDIGO CRUZETA	OBS.
	DESCRIÇÃO	CÓDIGO		COM CHAVETA	SEM CHAVETA	CURTO	LONGO			
28-178	1-FLANGE	28-097	---	---	30,00 - 1 3/16"	30,00	---	---	801039	6 furos 8,2mm - Disco Ø 105,00mm
	2-F.ORELHA	28-095	---	---	---	70,00	---	---		6 furos 8,2mm - Disco Ø 105,00mm
	3-TERMINAL	28-072	---	22,20 - 7/8"	---	71,00	---	3/8"		---
28-179	1-FLANGE	28-097	---	---	30,00 - 1 3/16"	30,00	---	---	801039	6 furos 8,2mm - Disco Ø 105,00mm
	2-F.ORELHA	28-095	---	---	---	70,00	---	---		6 furos 8,2mm - Disco Ø 105,00mm
	3-TERMINAL	28-094	---	---	27,00 - 1 1/16"	---	138,5	Graxeira 6mm		Terminal (Luva) 16 estrias - Estriado
28-180	1-FLANGE	28-098	---	---	30,00 - 1 3/16"	30,00	---	---	801039	4 furos 8,2mm - Disco Ø 105,00mm
	2-F.ORELHA	28-096	---	---	---	70,00	---	---		4 furos 8,2mm - Disco Ø 105,00mm
	3-TERMINAL	28-061	22,20 - 7/8"	---	---	71,50	---	8mm		---
28-188	1-FLANGE	28-181	---	---	28,50 - 1 1/8"	39,00	---	---	801039	4 furos 8,2mm - Disco Ø 97,70mm
	2-F.ORELHA	28-099	---	---	---	83,00	---	---		4 furos 8,2mm - Disco Ø 97,70mm
	3-TERMINAL	28-087	---	20,60 - 13/16"	---	71,5	---	3/8"		---
28-189	1-FLANGE	28-181	---	---	28,50 - 1 1/8"	39,00	---	---	801039	4 furos 8,2mm - Disco Ø 97,70mm
	2-F.ORELHA	28-099	---	---	---	83,00	---	---		4 furos 8,2mm - Disco Ø 97,70mm
	3-TERMINAL	28-068	---	22,18 - 1 1/4"	---	---	138,5	3/8"		---
28-190	1-FLANGE	28-181	---	---	28,50 - 1 1/8"	39,00	---	---	801039	4 furos 8,2mm - Disco Ø 97,70mm
	2-F.ORELHA	28-099	---	---	---	83,00	---	---		4 furos 8,2mm - Disco Ø 97,70mm
	3-TERMINAL	28-061	22,20 - 7/8"	---	---	71,50	---	8mm		---

CÓDIGO LNG	DESCRIÇÃO	SIMILAR CONCORRENTE		
		STAHL	AEMCO	STU
28-033	JUNTA	JU-810	JÁ-650	CR-110
28-034	JUNTA	JU-810	JÁ-651	CR-115
28-035	JUNTA	JU-811	JÁ-652	CR-545
28-036	JUNTA	JU-821	JÁ-654	CR-105
28-037	JUNTA	JU-836	JÁ-662	CR-155
28-038	JUNTA	JU-859	JÁ-689	CR-195
28-039	JUNTA	JU-833	JÁ-659	CR-140
28-044	JUNTA	---	JÁ-606	CR-125
28-045	JUNTA	---	JÁ-660	CR-185
28-046	JUNTA	---	JÁ-685	CR-500
28-049	JUNTA	JU-828	JÁ-658	CR-135
28-050	JUNTA	---	JÁ-679	CR-106
28-051	JUNTA	---	JÁ-688	CR-555
28-052	JUNTA	---	JÁ-656	CR-365
28-053	JUNTA	---	JÁ-677	CR-710
28-054	JUNTA	---	JÁ-819	CR-225
28-055	JUNTA	JU-820	JÁ-653	CR-215
28-056	JUNTA	JU-835	JÁ-661	CR-160
28-057	JUNTA	---	JÁ-605	CR-220
28-058	JUNTA	---	JÁ-682	CR-455
28-059	JUNTA	---	JÁ-683	CR-216
28-060	TERMINAL	---	TA-602	---
28-061	TERMINAL	---	CC-11	---
28-062	TERMINAL	---	CC-12	---
28-063	TERMINAL	---	CC-19	---
28-065	TERMINAL	---	CC-130	---
28-066	TERMINAL	---	TA-150	---
28-067	TERMINAL	---	TA-151	---
28-068	TERMINAL	---	TA-153	---

CÓDIGO LNG	DESCRIÇÃO	SIMILAR CONCORRENTE		
		STAHL	AEMCO	STU
28-069	TERMINAL	---	TA-155	---
28-070	TERMINAL	---	TA-156	---
28-071	TERMINAL	---	TA-157	---
28-072	TERMINAL	---	TA-164	---
28-073	TERMINAL	---	TA-170	---
28-074	TERMINAL	---	TA-172	---
28-075	TERMINAL	---	TA-173	---
28-076	TERMINAL	---	TA-174	---
28-077	TERMINAL	---	TA-182	---
28-078	TERMINAL	---	TA-197	---
28-079	TERMINAL	---	TA-601	---
28-080	TERMINAL	---	TA-603	---
28-081	TERMINAL	---	TA-604	---
28-082	TERMINAL	---	TA-605	---
28-083	TERMINAL	---	TA-606	---
28-084	TERMINAL	---	TA-609	---
28-085	TERMINAL	---	TA-610	---
28-086	TERMINAL	---	TA-611	---
28-087	TERMINAL	---	CC-103	---
28-088	TERMINAL	---	TA-615	---
28-089	TERMINAL	---	TA-616	---
28-090	TERMINAL	---	TA-617	---
28-091	TERMINAL	---	TA-621	---
28-092	TERMINAL	---	TA-628	---
28-093	GARFO	---	TA-152	---
28-094	LUVA	---	TA-158	---
28-095	FL. DE ORELHA	---	TA-160	---
28-096	FL. DE ORELHA	---	TA-161	---
28-097	FLANGE CONICA	---	TA-162	---

CÓDIGO LNG	DESCRIÇÃO	SIMILAR CONCORRENTE		
		STAHL	AEMCO	STU
28-098	FLANGE CONICA	---	TA-163	---
28-099	FL. DE ORELHA	---	TA-185	---
28-100	FL. DE ORELHA	---	TA-186	---
28-119	JUNTA	---	JÁ-660	CR-375
28-120	JUNTA	---	JÁ-655	CR-175
28-121	JUNTA	---	JÁ-667	CR-415
28-122	JUNTA	---	JÁ-681	CR-141
28-123	JUNTA	---	JÁ-601	CR-570
28-124	JUNTA	---	JÁ-676	CR-310
28-125	JUNTA	---	JÁ-694	CR-645
28-126	JUNTA	JU-837	JÁ-663	CR-646
28-127	JUNTA	---	JÁ-690	CR-540
28-128	JUNTA	---	JÁ-691	CR-535
28-129	JUNTA	---	JÁ-607	CR-355
28-130	JUNTA	---	JÁ-668	CR-290
28-131	JUNTA	---	JÁ-669	CR-280
28-132	JUNTA	---	JÁ-608	CR-285
28-133	JUNTA	---	JÁ-697	CR-680
28-134	JUNTA	---	JÁ-754	CRI-1285
28-135	JUNTA	---	JÁ-716	CRI-1185
28-136	JUNTA	---	JÁ-737	CRI-1571
28-137	JUNTA	---	JÁ-731	CRI-1106
28-138	JUNTA	---	JÁ-715	CRI-1111
28-139	JUNTA	---	JÁ-701	CRI-1110
28-140	JUNTA	---	JÁ-733	CRI-1240
28-141	JUNTA	---	JÁ-713	CRI-1155
28-142	JUNTA	---	JÁ-761	CRI-1195
28-143	JUNTA	---	JÁ-780	CRI-1190
28-144	JUNTA	---	JÁ-717	CRI-1136

CÓDIGO LNG	DESCRIÇÃO	SIMILAR CONCORRENTE		
		STAHL	AEMCO	STU
28-145	JUNTA	---	JÁ-714	CRI-1141
28-146	JUNTA	---	JÁ-703	CRI-1140
28-147	JUNTA	---	JÁ-734	CRI-1225
28-148	JUNTA	---	JÁ-805	CRI-1226
28-149	JUNTA	---	JÁ-735	CRI-1135
28-150	JUNTA	---	JÁ-742	CRI-1570
28-151	JUNTA	---	JÁ-804	CRI-1165
28-152	JUNTA	---	JÁ-736	CRI-1310
28-153	JUNTA	---	JÁ-726	CRI-1235
28-154	JUNTA	---	JÁ-748	CRI-1311
28-155	JUNTA	---	JÁ-773	CRI-1595
28-156	JUNTA	---	JÁ-738	CRI-1160
28-157	JUNTA	---	JÁ-741	CRI-1670
28-158	JUNTA	---	JÁ-823	CRI-1161
28-159	JUNTA	---	JÁ-784	CRI-1210
28-160	JUNTA	---	JÁ-724	CRI-1275
28-161	JUNTA	---	JÁ-720	CRI-1635
28-162	JUNTA	---	JÁ-766	CRI-1270
28-163	JUNTA	---	JÁ-753	CRI-1336
28-164	JUNTA	---	JÁ-792	CRI-1350
28-165	JUNTA	---	JÁ-752	CRI-1280
28-166	JUNTA	---	JÁ-730	CRI-1245
28-167	JUNTA	---	JÁ-700	CRI-1315
28-168	JUNTA	---	JÁ-745	CRI-1230
28-169	JUNTA C/FLANGE	---	JÁ-696	CR-475
28-170	JUNTA C/FLANGE	---	JÁ-687	CR-495
28-171	JUNTA C/FLANGE	---	JÁ-695	CR-575
28-172	JUNTA C/FLANGE	---	JÁ-771	CRI-1781
28-173	JUNTA C/FLANGE	---	JÁ-711	CRI-1480

CÓDIGO LNG	DESCRIÇÃO	SIMILAR CONCORRENTE		
		STAHL	AEMCO	STU
28-174	JUNTA C/FLANGE	---	JÁ-712	CRI-1482
28-175	JUNTA C/FLANGE	---	JÁ-710	CRI-1483
28-176	JUNTA C/FLANGE	---	JÁ-709	CRI-1711
28-177	JUNTA C/FLANGE	---	JÁ-728	CRI-1835
28-178	JUNTA C/FLANGE	---	JÁ-789	CRI-1875
28-179	JUNTA C/FLANGE	---	JÁ-772	CRI-1965
28-180	JUNTA C/FLANGE	---	JÁ-783	CRI-1435
28-181	FLANGE CONICA	---	TA-627	---
28-182	JUNTA	---	---	---
28-183	JUNTA	---	---	---
28-184	JUNTA	---	---	---
28-185	JUNTA	---	---	---
28-186	JUNTA	---	---	---
28-187	JUNTA	---	---	---
28-188	JUNTA C/FLANGE	---	---	---
28-189	JUNTA C/FLANGE	---	---	---
28-190	JUNTA C/FLANGE	---	---	---
28-191	JUNTA	---	---	---
28-192	JUNTA	---	---	---
801039	CRUZETA	CZ-101	CC-04	---
801104	CRUZETA	CZ-204	CC-201/1	---

CÓDIGO LNG	DESCRIÇÃO	SIMILAR CONCORRENTE		
		STAHL	AEMCO	STU

TIPO 1



TIPO 2



LEGENDA (posição da graxeira)

- LP - Lubrificação Permanente
- LB2 - Lubrificação através de furos em 2 castanhas
- LB4 - Lubrificação através de furos em 4 castanhas
- LB - Lubrificação através do fundo da castanha

Obs.: A medida "B" está em ordem crescente e em seguida "A"

CÓDIGO LNG	Diâmetro "B" (mm)	Comprimento "A" (mm)	Posição da Graxeira	Ref. STAHL ou DANA
------------	-------------------	----------------------	---------------------	--------------------

CRUZETA - TIPO 1

801126	17,00	45,40	LP	CZ-205
801046	18,00	54,90	LP	CZ-218
801060	19,00	48,20	LP	CZ-259
801104	19,00	48,20	CENTRO	CZ-204
801045	19,00	49,00	LP	CZ-260
801021	19,10	47,60	CENTRO	
801044	19,10	47,60	LP	
801092	22,00	57,80	CENTRO	CZ-190
801004	23,80	61,20	LP	CZ-122
801039	23,80	61,20	CENTRO	CZ-101
801066	23,80	62,00	LP	CZ-181
801118	23,80	62,00	LB2	CZ-138
801128	24,00	77,40	LP	CZ-268
801151	25,00	63,80	LB	
801167	25,00	63,80	LB	
801053	25,00	76,70	LB	CZ-299
801008	27,00	61,90	LB	CZ-120
801113	27,00	62,92	LB	CZ-133
801065	27,00	70,00	CENTRO	CZ-102
801064	27,00	70,10	LB2	CZ-117
801121	27,00	70,10	LB4	CZ-149
801090	27,00	70,40	LB2	CZ-187
801091	27,00	70,90	LP	CZ-189
801086	27,00	71,00	LB4	CZ-183

CÓDIGO LNG	Diâmetro "B" (mm)	Comprimento "A" (mm)	Posição da Graxeira	Ref. STAHL ou DANA
------------	-------------------	----------------------	---------------------	--------------------

801115	27,00	71,30	CENTRO	CZ-135
801079	27,00	74,60	CENTRO	CZ-127
801125	27,00	74,60	LATERAL	CZ-201
801114	27,00	74,70	LP	CZ-134
801049	27,00	80,00	LATERAL	CZ-170
801009	27,00	81,80	LATERAL	CZ-121
801145	27,00	81,80	LB	
801111	27,00	82,00	CENTRO	CZ-296
801132	27,00	82,00	LP	CZ-293
801133	27,00	82,00	LB	CZ-297
801019	27,00	92,00	LATERAL	CZ-252
801130	27,00	92,20	LP	CZ-291
801152	28,00	71,00	CENTRO	
801063	30,00	82,50	LB2	CZ-116
801120	30,00	82,50	LB4	CZ-148
801100	30,00	83,10	LB2	CZ-137
801011	30,10	92,00	LATERAL	CZ-208
801010	30,10	106,30	LATERAL	CZ-210
801089	30,20	81,60	LB2	CZ-186
801123	30,20	82,16	LB2	CZ-151
801131	30,20	106,30	LP	CZ-292
801080	32,00	75,80	CENTRO	CZ-140
801124	34,00	97,00	LB	CZ-188
801062	34,90	93,00	LP	CZ-182
801001	34,90	106,10	LATERAL	CZ-254

CÓDIGO LNG	Diâmetro "B" (mm)	Comprimento "A" (mm)	Posição da Graxeira	Ref. STAHL ou DANA
------------	-------------------	----------------------	---------------------	--------------------

801018	34,90	126,10	LATERAL	CZ-256
801087	35,00	96,70	CENTRO	CZ-184
801122	35,00	97,10	LB4	CZ-150
801088	35,00	97,50	LB2	CZ-185
801093	36,00	88,70	CENTRO	CZ-191
801041	38,00	147,80	CENTRO	CZ-287
801154	39,00	118,00	LATERAL	
801031	41,20	126,00	CENTRO	CZ-271
801022	41,20	141,90	LATERAL	CZ-221
801077	41,30	128,20	CENTRO	CZ-105
801096	42,00	122,00	CENTRO	
801159	42,00	122,00	CENTRO	
801094	44,00	126,00	LATERAL	CZ-220
801026	44,00	149,00	LATERAL	CZ-251
801002	45,00	120,30	CENTRO	CZ-228
801033	48,00	125,60	CENTRO	CZ-229
801032	48,00	160,90	CENTRO	CZ-265
801042	49,20	138,80	CENTRO	CZ-290
801074	49,20	150,80	CENTRO	5-12007X
801027	50,00	164,00	LATERAL	CZ-255
801029	52,00	132,90	CENTRO	CZ-230
801101	52,00	147,00	CENTRO	
801028	53,00	135,00	CENTRO	CZ-286
801040	55,00	164,00	CENTRO	CZ-284
801148	55,50	205,50	LATERAL(2)	

TIPO 1



TIPO 2



LEGENDA
(posição da graxeira)

- LP - Lubrificação Permanente
- LB2 - Lubrificação através de furos em 2 castanhas
- LB4 - Lubrificação através de furos em 4 castanhas
- LB - Lubrificação através do fundo da castanha

Obs.: A medida "B" está em ordem crescente e em seguida "A"

CÓDIGO LNG	Diâmetro "B" (mm)	Comprimento "A" (mm)	Posição da Graxeira	Ref.STAHL ou DANA
------------	-------------------	----------------------	---------------------	-------------------

CRUZETA - TIPO 1

801005	57,00	152,10	CENTRO	CZ-231
801030	57,00	163,90	CENTRO	CZ-277
801102	57,00	171,60	CENTRO	
801103	59,00	167,80	LATERAL	
801034	60,00	163,00	CENTRO	CZ-232
801035	65,00	171,80	CENTRO	CZ-289
801038	65,00	189,70	CENTRO	CZ-280
801135	74,00	180,00	LB	
801136	74,00	217,00	LB	
801137	83,00	219,00	LB	
801108	83,00	231,00	LB	
801138	83,00	231,40	LB	
801139	95,00	250,00	LB	
801140	110,00	251,50	LB	
801110	110,00	274,00	LB	
801107	130,00	300,00	LB	
801141	154,00	344,00	LB	

CRUZETA - TIPO 2

801054	20,00	34,80	LB	CZ-294
801158	24,60	32,40	CENTRO	
801068	24,60	38,80	LP	CZ-106
801076	24,60	38,80	CENTRO	CZ-104
801168	25,00	40,00	LB	
801155	25,00	52,00	LB	

CÓDIGO LNG	Diâmetro "B" (mm)	Comprimento "A" (mm)	Posição da Graxeira	Ref.STAHL ou DANA
------------	-------------------	----------------------	---------------------	-------------------

801166	26,00	53,60	LATERAL	
801052	26,10	55,20	LATERAL	
801050	26,50	47,20	LB	CZ-171
801164	27,00	46,10	LB	
801095	27,00	52,60	LP	CZ-226
801116	27,40	50,20	LP	CZ-136
801109	28,00	48,60	CENTRO	
801127	28,00	49,00	CENTRO	
801150	28,00	53,10	LB	
801149	28,00	54,50	LB	
801157	28,50	49,20	LB	
801056	29,00	47,40	CENTRO	CZ-298
801055	29,00	49,00	LATERAL	
801129	30,00	55,10	CENTRO	CZ-285
801085	30,10	52,80	LP	CZ-180
801051	32,00	56,90	CENTRO	CZ-172
801160	34,90	76,20	LATERAL	
801000	38,00	57,20	CENTRO	CZ-227
801146	38,00	57,20	LB(2)	CZ-227
801037	42,00	66,30	CENTRO	CZ-288
801036	68,00	89,00	CENTRO	CZ-276
801075	68,05	117,00	CENTRO	

CÓDIGO LNG	Diâmetro "B" (mm)	Comprimento "A" (mm)	Posição da Graxeira	Ref.STAHL ou DANA
------------	-------------------	----------------------	---------------------	-------------------

TIPO 3

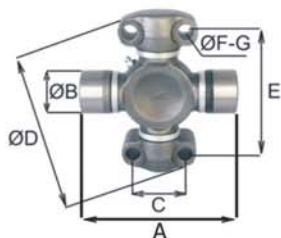

TIPO 4

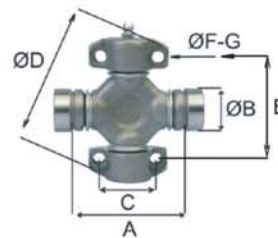

LEGENDA
(posição da graxeira)

- LP - Lubrificação Permanente
- LB2 - Lubrificação através de furos em 2 castanhas
- LB4 - Lubrificação através de furos em 4 castanhas
- LB - Lubrificação através do fundo da castanha

Obs.: A medida "B" está em ordem crescente e em seguida "A"

CÓDIGO LNG	Posição da Graxeira	Comprimento "A" (mm)	Diâmetro "B" (mm)	Comprimento "C" (mm)	Diâmetro "D" (mm)	Comprimento "E" (mm)	Diâmetro "F"	Diâmetro "G"	Ref. STAHL ou DANA
CRUZETA - TIPO 3									
801024	LATERAL	106,10	30,10	36,50	107,90	87	9,00		CZ-112
801097	LATERAL	106,20	30,10	42,50	115,00	89	10,40		CZ-266
801073	LATERAL	106,10	34,90	42,50	115,00	89		UNF 3/8"	CZ-177
801083	LATERAL	106,10	34,90	42,70	115,00	89	10,50		CZ-176
801025	LATERAL	126,10	34,90	42,50	140,50	114,4	10,40		CZ-108
801078	LATERAL	126,10	34,90	42,50	140,50	114,6		UNF 3/8"	CZ-114
801007	LATERAL	141,90	41,20	49,10	148,30	117,4	13,50		CZ-128
801071	LATERAL	141,90	41,20	49,10	148,30	117,4	12,50		CZ-250
801098	LATERAL	142,00	41,20	49,10	148,40	117,4	12,00		5-12450X
801099	LATERAL	142,00	41,20	49,10	148,40	117,4		UNF 7/16"	5-331X
801170	LP	174,10	52,37	71,30				UNF 1/2"	
801153	LATERAL(2)	205,50	55,50	71,70					
801161	LATERAL(2)	167,40	58,90	71,70					
CRUZETA - TIPO 4									
801061	LATERAL	54,70	25,40	33,30	79,20	59,6		UNF 5/16"	CZ-107
801105	LATERAL	83,80	32,00	42,80	115,00	89	10,5		
801106	LATERAL	89,80	33,33	42,80	140,50	114,6	10,4		

TIPO 5

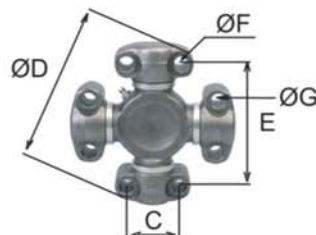

LEGENDA (posição da graxeira)

- LP - Lubrificação Permanente
- LB2 - Lubrificação através de furos em 2 castanhas
- LB4 - Lubrificação através de furos em 4 castanhas
- LB - Lubrificação através do fundo da castanha

Obs.: A medida "C" está em ordem crescente e em seguida "D"

CÓDIGO LNG	Posição da Graxeira		Comprimento "C" (mm)	Diâmetro "D" (mm)	Comprimento "E" (mm)	Diâmetro "F"	Diâmetro "G"	Ref. STAHL ou DANA	
CRUZETA - TIPO 5									
801048	LATERAL		33,30	79,20	59,6	8,5		CZ-179	
801069	LATERAL		33,30	79,20	59,5	8,5	UNF 5/16"	CZ-125	
801081	LB		36,50	90,50	69,5	9	UNF 5/16"	CZ-173	
801003	LATERAL		36,50	107,90	86,9	9		CZ-110	
801072	LATERAL		36,50	107,90	87,2		UNF 5/16"	CZ-175	
801112	LATERAL		36,50	107,90	87	9,2		CZ-131	
801016	LATERAL		42,50	140,50	114,6	10,4		CZ-109	
801023	LATERAL		42,50	140,50	114,6		UNF 3/8"	CZ-126	
801084	LATERAL		42,50	140,50	114,6	10,5	UNF 3/8"	CZ-178	
801059	LB		42,70	115,00	89	10,4		CZ-123	
801070	LATERAL		42,70	115,00	89	10,4		CZ-115	
801082	LATERAL		42,70	115,00	89		UNF 3/8"	CZ-174	
801017	LATERAL		49,10	148,30	117,4	13,5		CZ-113	
801067	LATERAL		49,10	148,30	117,4		UNF 7/16"	CZ-111	
801169	LATERAL		49,20	130,00	104,1	11,1			
801163	LATERAL		49,20	206,20	174,6	13	UNF 1/2"		
801165	LATERAL		49,20	206,20	174,6	7/16"			
801047	LB		71,50	165,10	123,6	14		CZ-143	
801058	LATERAL		71,50	165,10	123,6		UNF 1/2"	CZ-144	
801057	LB		71,50	209,50	168,5	14		CZ-142	

TIPO 6

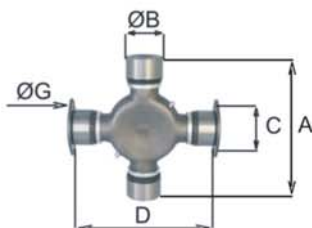

TIPO 7

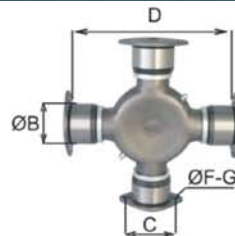

LEGENDA
(posição da graxeira)

- LP - Lubrificação Permanente
- LB2 - Lubrificação através de furos em 2 castanhas
- LB4 - Lubrificação através de furos em 4 castanhas

Tipo 6: Diâmetro "B" em ordem crescente e depois dimensão "A"
Tipo 7: Diâmetro "B" em ordem crescente e depois dimensão "C"

CÓDIGO LNG	Posição da Graxeira	Comprimento "A" (mm)	Diâmetro "B" (mm)	Comprimento "C" (mm)	Comprimento "D" (mm)	Diâmetro "F"	Diâmetro "G"	Ref. STAHL ou DANA
CRUZETA - TIPO 6								
801020	LATERAL	134,80	47,60	59,00	134,8		UNF 5/16"	CZ-264
801006	LATERAL	157,00	49,20	61,90	154,7		UNF 3/8"	CZ-274
801162	LATERAL	178,80	49,20		178,8			-
801015	LATERAL	194,10	49,20	61,90	191,8		UNF 3/8"	CZ-272
CRUZETA - TIPO 7								
801043	LATERAL		47,60	59,00	134,8	M8 X 1,25		CZ-257
801156	LATERAL		49,20	61,80	135,1	13,00	UNF 1/2"	
801012	LATERAL		49,20	61,90	154,7		UNF 5/16"	CZ-124
801013	LATERAL		49,20	61,90	191,8	10,50		CZ-273
801014	LATERAL		50,00	56,00	152,3		UNF 3/8"	CZ-270
801153	LATERAL(2)		55,50	71,70	205,5		UNF 7/16"	
801161	LATERAL(2)		58,90	71,70	167,4		UNF 3/8"	